



Weald Road, Brentwood, CM14

BUTLER & STAG



Guide Price £230,000-£240,000.
Occupying a prime position in the heart of Brentwood's vibrant high street is this simply stunning one bedroom first floor apartment set only a short walk from all of Brentwood's finest bars & restaurants, plus Brentwood Mainline Railway Station with easy access to London Liverpool Street.



Leasehold

- One Bedroom First Floor Apartment
- Stylish Open Plan Lounge/Kitchen
- Lift Access
- Stamp Duty Exempt For First Time Buyers
- Stunning Throughout
- Underfloor Heating
- Secure Video Entry System
- 246 Years Remaining Lease

Internally, the property finish throughout is second to none. Positioned on the first floor, the apartment offers the modern day main living space of an open plan kitchen/living space with floor to ceiling windows stand allowing an abundance of light to flow through into the room measuring almost 25ft ft in length. The kitchen area is fitted with a range of contemporary units alongside a range of fitted appliances including, induction hob, fridge/freezer washer/dryer & dishwasher. There is a good-sized carpeted bedroom again with floor to ceiling windows and fully fitted shower room situated off of the main hallway which completes the floor space. The apartment also benefits from under floor heating.

Weald Road is positioned in the heart of Brentwood's vibrant High Street with the added benefit of also only being a short walk the Brentwood station and with the opening of the Elizabeth Line, Brentwood station offers a direct 23-minute service to Central London, Heathrow and beyond. There is also fantastic links within a ten minutes commute by car to M25/A12.





The Apartments, CM14

First Floor

Approx. 42.08 Sq. meters (453 Sq. feet)

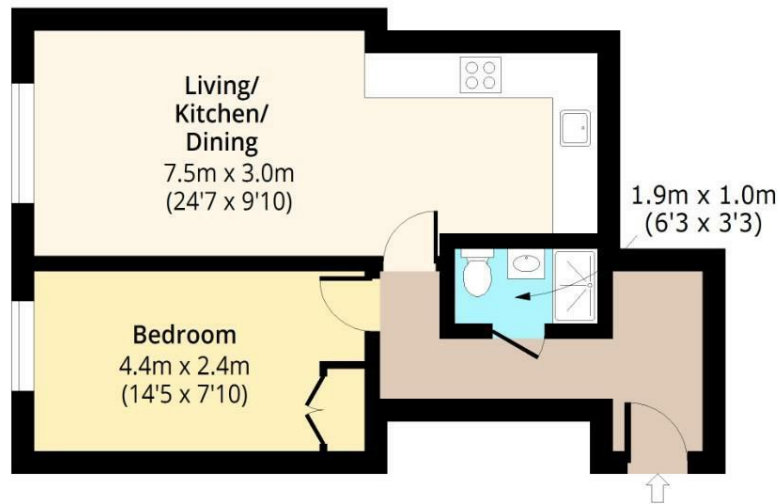

Total area: approx. 42.08 Sq. meters (453 Sq. feet)

For illustration purposes only - not to scale

www.lpaplus.com

IMPORTANT NOTICE - These particulars have been prepared in good faith and they are not intended to constitute part of an offer or contract. We have not performed a structural survey on this property and the services, appliances or specific fittings have not been tested. All photographs, measurements, floor plans and distances referred to are given as a guide and should not be relied upon.

BUTLER & STAG

☎ 01992 667666

🏠 4 Forest Drive, Theydon Bois, Essex, CM16 7EY

✉ theydon@butlerandstag.com

www.butlerandstag.uk